

REASSEMBLY

1. **INSTALL FRONT DOOR WEATHERSTRIP NO. 2**
2. **INSTALL FRONT DOOR WEATHERSTRIP**
3. **INSTALL FRONT DOOR OUTSIDE HANDLE WITH LOCK CYLINDER**
 - (a) Install the lock cylinder to the front door outside handle with the bolt.
Torque: 5.5 N·m (56 kgf·cm, 49 in.-lbf)
 - (b) Install the front door outside handle with lock cylinder with the 2 bolts.
Torque: 5.5 N·m (56 kgf·cm, 49 in.-lbf)
 - (c) Install the service hole plug.

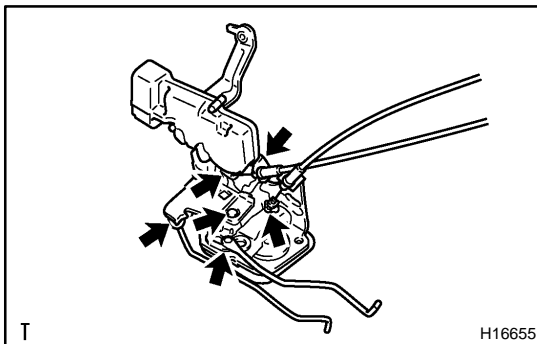

4. **INSTALL FRONT DOOR LOCK**

HINT:

Apply MP grease to the sliding and rotating parts of the front door lock.

- (a) Install the front door lock cover to the front door lock with the 2 screws.

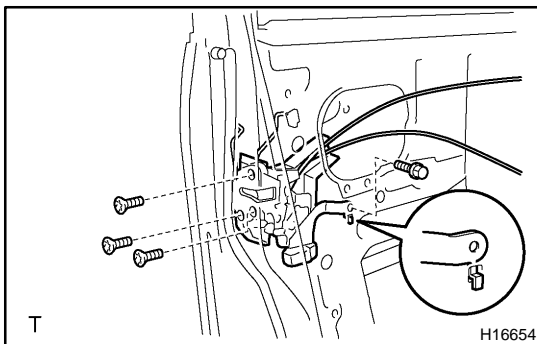

- (b) Using a torx® socket wrench, install the front door lock with the 3 torx® screws.

Torx® socket wrench:

T30 (Part No. 09042-00010 or locally manufactured tool)

Torque:

5.0 N·m (51 kgf·cm, 44 in.-lbf) for bolt

5.0 N·m (51 kgf·cm, 44 in.-lbf) for screw

HINT:

Apply adhesive to the 3 screws.

Adhesive: Part No. 08833-00070, THREE BOND 1324 or equivalent.

- (c) Connect the connector and tighten the bolt.
- (d) Connect the 2 control links to the front door outside handle and front door lock cylinder.
- (e) Install the front door lock control link protector with the screw.
- (f) Install the clamp.
- (g) Connect the 2 control cables to the clamp.

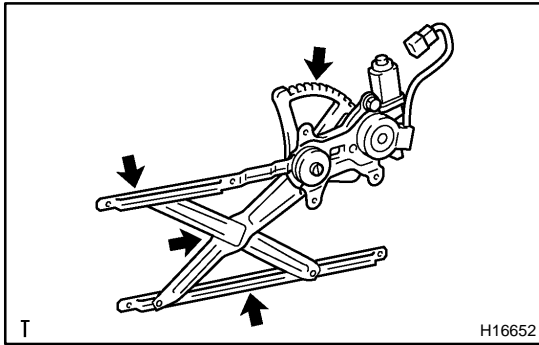

5. INSTALL FRONT DOOR POWER WINDOW REGULATOR

HINT:

Apply MP grease to the sliding and rotating parts of the front door power window regulator.

- (a) Install the power window regulator motor to the front door power window regulator with the 3 screws.

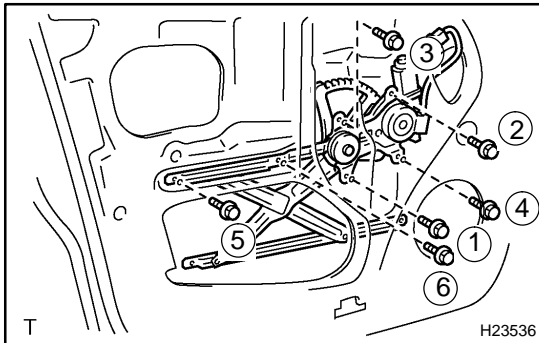

- (b) Install the front door power window regulator with the 6 bolts.

Torque: 8.0 N·m (82 kgf·cm, 71 in.-lbf)

HINT:

Tighten the 6 bolts in the order shown in the illustration.

- (c) Connect the connector.

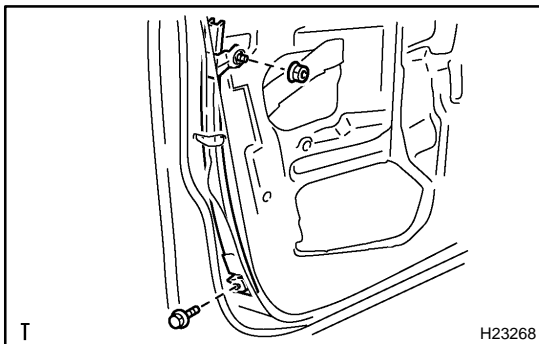

6. INSTALL FRONT DOOR FRAME REAR LOWER

Install the front door frame rear lower with the bolt and nut.

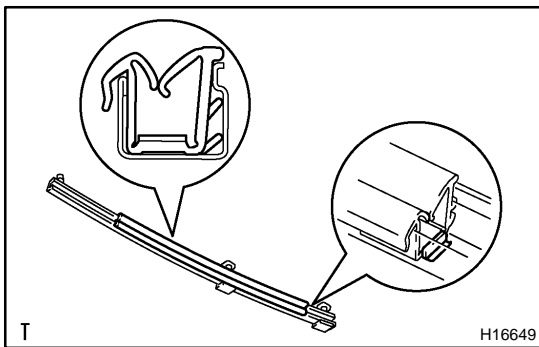

7. INSTALL FRONT DOOR FRAME FRONT LOWER

- (a) Install the front door glass run No. 2 to the front door frame front lower.

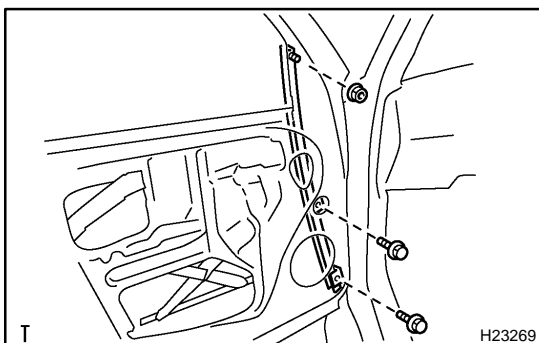

- (b) Install the front door frame front lower with the 2 bolts and nut.

8. INSTALL FRONT DOOR BELT MOULDING

9. INSTALL FRONT DOOR WINDOW FRAME MOULDING UPPER

10. INSTALL FRONT DOOR GLASS RUN

11. INSTALL FRONT DOOR GLASS

Torque: 8.0 N·m (82 kgf·cm, 71 in.-lbf)

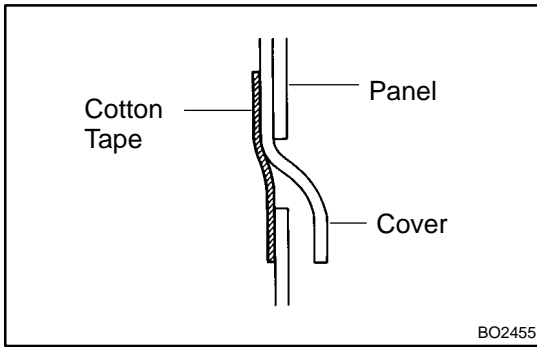

12. INSTALL FRONT DOOR SERVICE HOLE COVER

- (a) Install the front door service hole cover.

HINT:

- When installing the service hole cover, pull out the cables and connectors through the service hole cover.
- There should be no wrinkles or folds after attaching the service hole cover.
- After attaching the service hole cover, confirm the sealing condition.

- (b) Connect the clamps and connector.

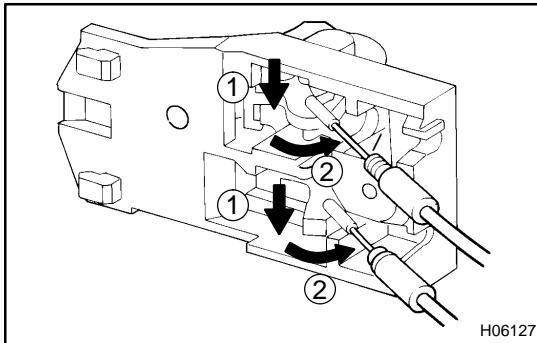

13. INSTALL FRONT DOOR INSIDE HANDLE

- (a) Connect the 2 cables to the inside handle.

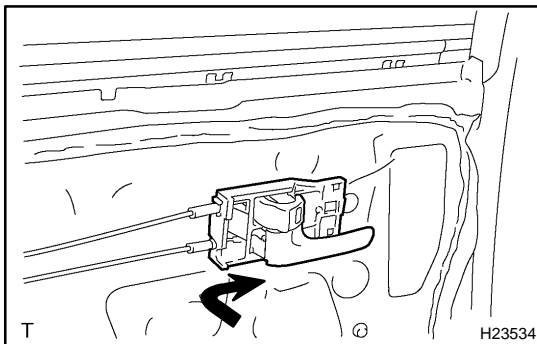

- (b) Slide the inside handle forward to install it.

14. INSTALL SPEAKER

15. INSTALL OUTER REAR VIEW MIRROR

Torque: 8.0 N·m (82 kgf·cm, 71 in.-lbf)

16. INSTALL TWEETER SPEAKER

17. INSTALL FRONT DOOR TRIM PANEL

18. INSTALL FRONT DOOR LOWER FRAME BRACKET GARNISH

19. INSTALL FRONT ARMREST BASE PANEL UPPER WITH POWER WINDOW SWITCH

20. INSTALL COURTESY LIGHT

21. INSTALL DOOR INSIDE BEZEL